

# Gunnebo Anja Shackles



High quality wire rope  
and chain fittings



**GUNNEBO**  
LIFTING

# GUNNEBO-ANJA AS

## The Norwegian Forging Specialist

Andr. Jacobsen AS was established in 1918. The company is located on an island close to Bergen on the Norwegian west coast. The firm has grown to become the leading Scandinavian manufacturer of forged shackles and riggingscrews. Other main product lines are general forgings, eyebolts and wooden blocks.

The manufacturing program is constantly enlarged to meet our customers varying demands. Thus the company stands out as the single point supplier.

The products are made from a range of steel qualities including stainless acid proof steel and high grade alloy steel to comply with the most stringent specifications.

Our workshops comprise all facilities and systems for the manufacturing and control of top quality products. This include tool design, advanced tool shop, forging, heat treatment, machining, hot dip galvanizing and quality control.

As a proof of our constant work to maintain a high standard of quality the company is certified in accordance with the ISO 9001-2000 standard. The company was bought by Gunnebo in 2001 and changed name to Gunnebo-Anja AS



Andr. Jacobsen AS ble etablert i 1918 og er lokalisert på Osterøy ca 30 km nordøst for Bergen sentrum. Firmaet har utviklet seg til å bli Skandinavias ledende produsent av sjakler og strekkskruer. Andre hovedartikler er smidde og maskinerte detaljer for ulike formål, øyebolter og treblokker.

Produktene fremstilles i ulike utførelser og materialkvaliteter – inklusive seigherdingsstål og syrefast stål. Dette sammen med konstant produktutvikling gjør at våre kunder kan få dekket sitt komplette behov fra en produsent.

Vårt produksjonsutstyr dekker alle faser fra verktøykonstruksjon, fremstilling av verktøy, smiing, bearbeiding, varmebehandling, varmgalvanisering og sertifisering. Sammen med høyt kvalifiserte medarbeidere er dette grunnlaget for at firmaets kvalitetsikringssystem er sertifisert i samsvar med ISO 9001-2000. Bedriften ble kjøpt av Gunnebo i 2001 og endret navn til Gunnebo-Anja AS

## GENERAL INFORMATION

---

The main product lines presented in this catalogue are:

- Shackles
- Riggingscrews
- Thimbles
- Eyebolts
- Stainless Fittings
- Wooden Blocks

We consider it our obligation to satisfy our customers´ complete requirements for the above articles. Therefore we endeavour to maintain an adequate stock level in our modern warehouse for quick service of the various demands.

It is recommended that articles are ordered by specifying the appropriate art. number and size needed.



Følgende produksjonsprogram presenteres i denne katalogen:

- Sjakler
- Strekkskruer
- Kauser
- Øyebolter
- Rustfrie artikler
- Treblokker

Vi tar ansvar for å levere et komplett program av ovenstående artikler. Et omfattende lager av ferdige produkter sikrer hurtige leveranser av våre kunders behov. Ved bestilling bør artikkelnummer og dimensjon spesifiseres.

## DEFINITIONS

---

### **Working Load Limit (WLL)**

The maximum load a component or lifting assembly is authorized to take in general use under straight pull. The WLL is often known as Safe Working Load (SWL).

### **Proofload (PL)**

The maximum load applied when prooftesting a component or lifting assembly. The tested item may not show visible permanent deformation after proofloading.

### **Minimum Breaking Load (MBL)**

The minimum load under straight pull at which the component or lifting assembly may break.

### **Safety Factor (S.F.)**

The ratio between the MBL divided by WLL, for instance 6,0

### **Shockload**

A resulting load from impacting or jerking a static load. A shockload is generally much larger than the static load and great care should be taken to avoid such hazardous loads.

### **Største tillatte arbeidslast (WLL)**

Største tillatte belastning utstyret kan utsettes for under rent strekk. Ofte benyttes forkortelsen SWL (Safe Working Load) synonymt med WLL.

### **Prøvelast (PL)**

Største last som påføres en detalj eller redskap under prøvebelastning av denne, f.eks. i forbindelse med sertifisering. For løft gjelder typisk at  $PL = 2 \times WLL$ .

### **Minimum bruddlast (MBL)**

Minste last som under rent strekk medfører brudd i en komponent.

### **Sikkerhets faktor (S.F.)**

$S.F. = MBL : WLL$ , f.eks. 6,0 basert på katalogdata for Anja U.S. sjakler.

### **Sjokklast**

En resulterende last fra slag eller rykk fra en statisk last. En sjokklast kan gi svært høye momentanverdier og bør unngås.

## Anja U.S. Anchor Shackles

- Standard: U.S. Fed. Spec. RR-C-271
- Material: High Tensile Steel, Quenched and tempered / Legert stål, seigherdet
- Finish: All parts hot dip galvanized, painted bolts/pins on top of galv/  
Varmforsinket bøyle og bolt
- Safety factor: 6,0/Sikkerhetsfaktor : 6,0
- Documentation: Test certificate and traceable 3.1.B certificate / Leveres med prøvesertifikat og 3.1.B materialsertifikat.

Art.no	WLL tons	Nominal size d	Bolt dia d 1	Inside width a	Inside length c	Outside eye d 2	Inside bow e	Weight Safety Bolt	Weight Screw Pin
Ref. figure	0,33	3/16" - 5	6	10	22	13	16	0,02	
Ref. figure	0,5	1/4" - 6	8	12	29	16	20	0,07	0,06
Ref. figure	0,75	5/16" - 8	10	13	32	20	21	0,13	0,11
Ref. figure	1,0	3/8" - 9	11	16	36	22	26	0,17	0,15
Ref. figure	1,5	7/16" - 11	13	18	43	26	29	0,25	0,21
Ref. figure	2,0	1/2" - 13	16	21	47	33	33	0,42	0,37
Ref. figure	3,25	5/8" - 16	19	27	60	40	42	0,7	0,65
Ref. figure	4,75	3/4" - 19	22	31	71	47	51	1,2	1,1
Ref. figure	6,5	7/8" - 22	25	37	84	50	58	1,7	1,5
Ref. figure	8,5	1" - 25	28	43	95	58	68	2,5	2,2
Ref. figure	9,5	1.1/8" - 28	30*	46	108	64	74	3,4	3,1
Ref. figure	12,0	1.1/4" - 32	35	52	119	72	83	4,8	4,2
Ref. figure	13,5	1.3/8" - 35	38	57	132	74	89	7,0	6,0
Ref. figure	17,0	1.1/2" - 38	42	60	146	84	98	9,0	8,0
Ref. figure	25,0	1.3/4" - 45	50	74	178	105	127	15,0	13,5
Ref. figure	35,0	2" - 50	57	83	197	127	138	21,0	19,0
Ref. figure	42,5	2.1/4" - 57	65	95	222	140	160	29,0	
Ref. figure	55,0	2.1/2" - 65	70	105	255	152	185	41,0	38,0
Ref. figure	85,0	3" - 75	80	127	330	165	190	62,0	
Ref. figure	120,0	3.1/2" - 89	95	146	380	203	235	110,0	

Forging tolerances: +/- 5% on inside width/length

\*= 32 for 853/854

Safety Bolt / Mutterbolt

Ref. 855

Art.no.: A085506-89 (dim)

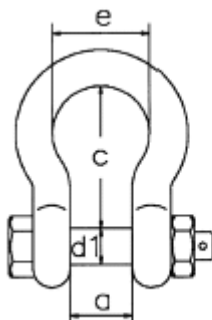

Screw Pin / Øyepinn

Ref. 854

Art.no.: A085405-64 (dim)

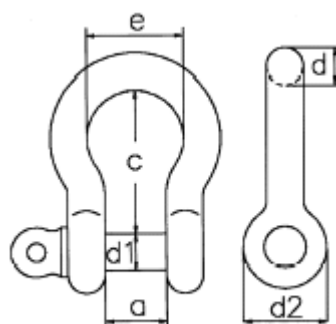

Trawling Pin / Trålpinn

Ref. 853

Art.no.: A085313-45 (dim)

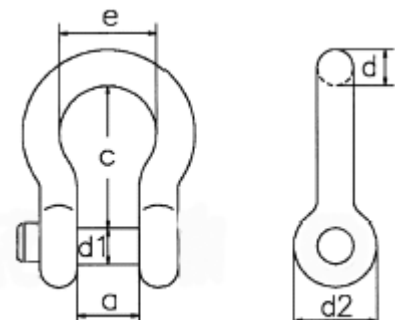

# SHACKLES

## Anja U.S. Chain Shackles

- Standard: U.S. Fed. Spec. RR-C-271
- Material: High Tensile Steel, Quenched and Tempered/Legert stål, seigherdet
- Finish: All parts hot dip galvanized, red painted bolts/pins on top of galv./ Varmforsinket bøyle og bolt.
- Safety factor: 6,0/Sikkerhetsfaktor : 6,0
- Documentation: Test certificate and traceable 3.1.B certificate / Leveres med prøvesertifikat og 3.1.B materialsertifikat.

Art.no	WLL tons	Nominal size d	Bolt dia d1	Inside width a	Inside length c	Outside eye d2	Weight Safety Bolt	Weight Screw Pin
Ref. figure	0,5	1/4" - 7	8	12	25	12		0,06
Ref. figure	0,75	5/16" - 9	10	13,5	27	16		0,11
Ref. figure	1,0	3/8" - 10	11	17	31	20		0,15
Ref. figure	1,5	7/16" / - 11	12	18,5	37	22		0,2
Ref. figure	2,0	1/2" - 13	16	2	41	33	0,30	0,25
Ref. figure	3,25	5/8" - 16	19	27	51	40	0,60	0,55
Ref. figure	4,75	3/4" - 19	22	31	60	47	1,10	1,0
Ref. figure	6,5	7/8" - 22	25	37	71	50	1,50	1,3
Ref. figure	8,5	1" - 25	28	43	81	58	2,2	1,9
Ref. figure	9,5	1.1/8" - 28	32*	46	90	64	3,1	2,8
Ref. figure	12,0	1.1/4" - 32	35	52	100	72	4,2	3,6
Ref. figure	13,5	1.3/8" - 35	38	57	111	74	5,6	4,6
Ref. figure	17,0	1.1/2" - 38	42	60	122	84	7,5	6,5
Ref. figure	25,0	1.3/4" - 45	50	74	149	105	13,0	11,5
Ref. figure	35,0	2" - 50	57	83	171	127	18,0	16,0
Ref. figure	55,0	2.1/2" - 65	70	105	203	152		

Forging tolerances: +/- 5% on inside width/length

\* = 30 for type 835

Safety Bolt / Mutterbolt

Ref. 835

Art.no.: A083513-64 (dim)

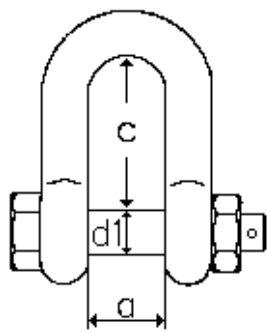

Screw Pin / Øyepinn

Ref. 834

Art.no.: A083405-45 (dim)

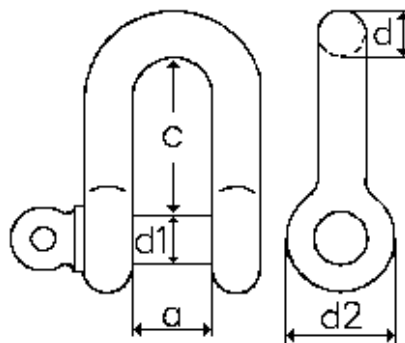

Trawling Pin / Trålpinn

Ref. 833

Art.no.: A083313-45 (dim)

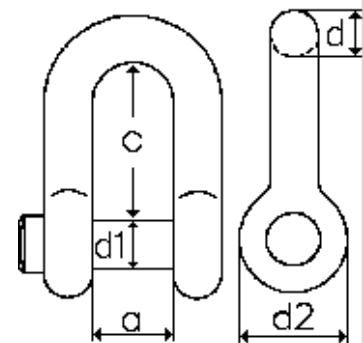

## Anja U.S. «Offshore» Shackles

- Standard: DnV 2.7.1 / U.S. Fed. Spec. RR-C-271/DNV Type Approval Pending.
- Material: Special Alloy Steel, Quenched and Tempered  
Høylegert stål, seigherdet.
- Finish: All parts hot dip galvanized + colour marking  
Varmgalvanisert og merkefarge.
- Safety factor: As per DnV 2.7.1 (8,0 - 6,0)  
Sikkerhetsfaktor i følge DnV 2.7.1
- Documentation: Test certificate and traceable 3.1.B certificate of the bow and the bolt in finished condition  
Leveres med prøvesertifikat og sporbart materialsertifikat for bøyle og bolt i leveringstilstand.

Art.no	WLL tons	Nominal size d	Bolt dia d1	Inside width a	Inside length c	Outside eye d2	Inside bow e	Weight Safety Bolt
A085613	2,0	1/2" - 13	16	21	47	33	33	0,42
A085616	3,25	5/8" - 16	19	27	60	40	42	0,7
A085619	4,75	3/4" - 19	22	31	71	47	51	1,2
A085622	6,5	7/8" - 22	25	37	84	50	58	1,7
A085625	8,5	1" - 25	28	43	95	58	68	2,5
A085628	9,5	1.1/8" - 28	32	46	108	64	74	3,4
A085632	12,0	1.1/4" - 32	35	52	119	72	83	4,8
A085635	13,5	1.3/8" - 35	38	57	132	74	89	7,0
A085638	17,0	1.1/2" - 38	42	60	146	84	98	9,0
A085645	25,0	1.3/4" - 45	50	74	178	105	127	15,0
A085652	35,0	2" - 50	57	83	197	127	138	21,0
A085664	55,0	2.1/2" - 65	70	105	255	152	185	41,0
A085676	85,0	3" - 75	80	127	330	165	190	62,0
A085689	120,0	3.1/2" - 89	95	146	380	203	235	110,0

Forging tolerances: +/- 5% on inside width/length

Safety Bolt / Mutterbolt  
Ref. 856

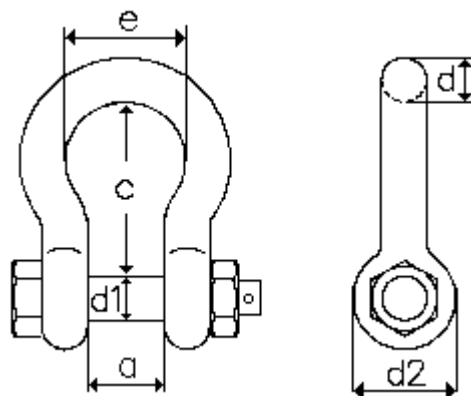

# SHACKLES

## Anja Mooring Bolts – Fortøyningsbolter

Material: Quenched and Tempered / Seigherdet  
 Finish: Hot dip galvanized / varmgalvanisert

Art.no	Dim	Ø - legg	Legg L	Hol øye E	G	K	S	Min. tonnbelastning v/bøy	v/brudd
A825032	1 1/4" x 16"	32	400	38	72	100	2	8	40
A825038	1 1/2" x 20"	38	500	46	84	100	2	12	60
A825045	1 3/4" x 24"	45	600	54	105	100	2	15	80

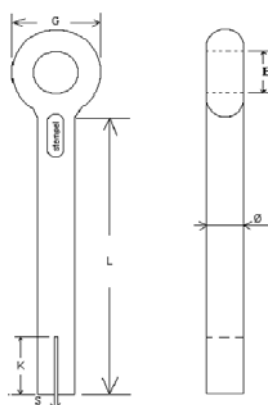

## Anja Mooring Shackles – Fortøyningssjakler

Material: Quenched and Tempered / Seigherdet  
 Finish: Hot dip galvanized / varmgalvanisert

Art.no	Tau diameter	Minste bruddlast tonn	Bøyle diameter d	Bolt diameter d1	Gap A	Innvendig bredde E	Innvendig lengde C
A085219	32	28	19	22	44	58	100
A085222	40	40	22	25	52	68	125
A085228	48	60	28	28	62	89	150
A085232	64	90	32	32	82	98	170

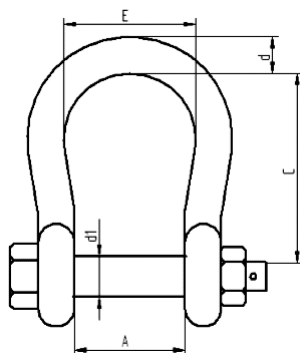

## Anja «Heavy Duty» Shackles

Anchor Shackle with Safety Bolt and splitpin – Harpeformet bøyle, bolt med mutter og splitpinn.

High tensile steel Quenched and Tempered – Legert stål, seigherdet.

Painted surface – Malt overflate.

Supplied with proof load test certificate and 3.1.B material certificates for bow and bolt.

Leveres med prøvesertifikat og 3.1. B materialsertifikat for bøyle og bolt.

WLL tons S.F = 5	Nominal size d	Bolt dia d1	Inside width a	Inside length c	Inside bow e	Outside eye d2	Approx weigh each
150,0	105	108	165	400	275	216	153,0
200,0	120	130	175	500	290	242	210,0
250,0	125	140	200	540	305	254	260,0
300,0	140	150	200	600	305	280	335,0
400,0	170	175	225	650	325	330	570,0
500,0	180	185	250	700	350	360	630,0
600,0	200	205	275	700	375	410	980,0
700,0	200	215	300	700	400	430	1030,0
800,0	210	220	300	700	400	440	1100,0
1000,0	240	240	340	700	420	480	1500,0
1200,0	250	280	400	800	500	560	1900,0

Forging tolerances: +/- 5% on inside width/length

### Safety Bolt / Mutterbolt

Ref. 857

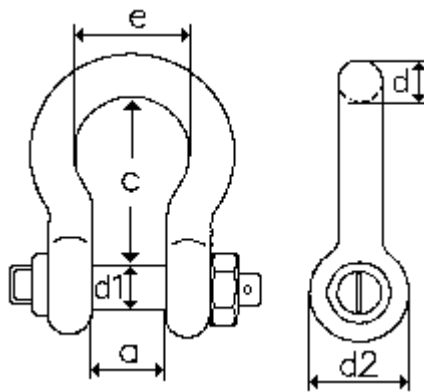

# SHACKLES

## Anja «Red Alloy» Chain Shackles

- Standard: Dimensions generally as per SMS 1577  
Hovedmål i følge svensk standard SMS 1577
- Material: Special Alloy Steel, Quenched and Tempered  
Høylegert stål, seigherdet
- Finish: Red Painted  
Rødmalt bøyle og bolt
- Safety factor: 4,0  
Sikkerhetsfaktor 4,0
- Documentation: Supplied with Test Certificate  
Leveres med prøvesertifikat.

Art.no	WLL tons S.F= 4,0	Nominal size	To fit chain size	Bow dia d	Bolt dia d1	Inside width a	Inside length c	Outside eye d2	Weight pcs kg
A831310	2,0	M10	7/8	8,5	10	15	30	20	0,10
A831312	3,2	M12	10	11	12	20	39	26	0,20
A831316	5,4	M16	13	13	16	24	52	33	0,40
A831320	8,0	M20	16	16	20	28	65	42	0,65
A831322	10,5	M22	18	18	22	30	72	46	0,90
A831324	12,5	M24	20	19	25	32	78	50	1,10
A831327	15,5	M27	22	22	28	36	86	55	1,70
A831330	19,0	M30	25	25	30	40	94	62	2,50
A831333	23,0	M33	26	28	32	44	103	68	3,10
A831339	32,0	M39	30	32	38	48	116	75	4,50
A831342	40,0	M42	32-33	35	42	52	129	82	5,70

Forging tolerances: +/- 5% on inside width/length

Safety Bolt / Mutterbolt  
Ref. 831

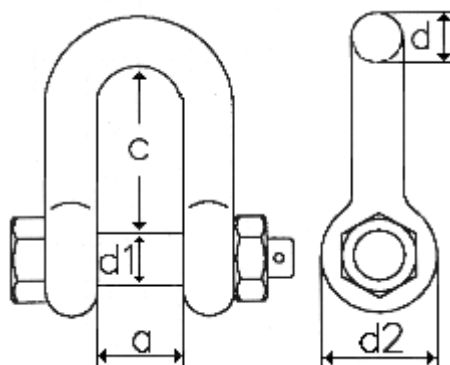

## Anja «Red Alloy» Anchor Shackles

- Standard: Dimensions generally as per SMS 1619.  
Hovedmål i følge svensk standard SMS 1619
- Material: Special Alloy Steel, Quenched and Tempered  
Høylegert stål, seigherdet.
- Finish: Red painted  
Rødmalt bøyle og bolt.
- Safety factor: 4,0  
Sikkerhetsfaktor 4,0
- Documentation: Supplied with Test Certificate  
Leveres med prøvesertifikat.

Art.no	WLL tons S.F=4,0	Nominal size d1	To fit chain size	Bow dia d	Bolt dia d1	Inside Width a	Inside Length c	Inside Bow e	Outside eye d2	Weight pcs kg
A851310	2,0	M10	7/8	11	10	15	34	26	20	0,13
A851312	3,2	M12	10	13	12	20	45	35	26	0,25
A851316	5,4	M16	13	16	16	24	55	42	33	0,50
A851320	8,0	M20	16	19	20	28	65	50	40	0,85
A851322	10,5	M22	19	22	22	30	70	52	46	1,20
A851324	12,5	M24	20	25	25	32	75	56	50	1,60
A851327	15,5	M27	22	28	28	36	85	62	55	2,20
A851330	19,0	M30	24	32	30	40	94	68	62	4,40
A851333	23,0	M33	26	35	32	44	104	77	68	5,70
A851339	32,0	M39	30	38	38	48	115	84	75	7,50
A851340	40,0	M42	32-33	42	42	52	125	92	82	7,50

Forging tolerances: +/- 5% on inside width/length

Safety Bolt / Mutterbolt  
Ref. 851

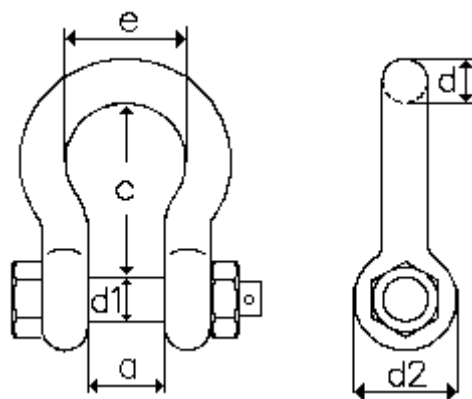

# SHACKLES

## Anja SMS 1577 Chain Shackles

- Standard: SMS 1577
- Material: High Tensile Steel, Normalized / Normalisert St. 52-3
- Finish: All types Hot Dip Galvanized  
Alle varianter leveres varmgalvanisert
- Safety factor: 5,0 / Sikkerhetsfaktor 5,0
- Documentation: Test certificate can be supplied on request / Kan leveres med prøvesertifikat når det forlanges.

Art.no	WLL Tons S.F.=5	Nominal size d1	Bow dia d	Inside width a	Inside length c	Outside eye d2	Weight pcs kg
Ref. figure	0,6	M10	8,5	15	30	20	0,10
Ref. figure	0,9	M12	11	20	39	26	0,20
Ref. figure	1,5	M16	13	24	52	33	0,40
Ref. figure	2,4	M20	16	28	65	42	0,65
Ref. figure	3,0	M22	18	30	72	46	0,90
Ref. figure	3,7	M24	19	32	78	50	1,10
Ref. figure	4,8	M27	22	36	86	55	1,70
Ref. figure	6,0	M30	25	40	94	62	2,50
Ref. figure	7,5	M33	28	44	103	68	3,10
Ref. figure	9,4	M39	32	48	116	75	4,50
Ref. figure	12,0	M42	35	52	129	82	5,70
Ref. figure	15,0	M45	38	58	143	84	10,00
Ref. figure	19,0	M52	45	64	155	95	14,00

Forging tolerances: +/- 5% on inside width/length.

Ref. 1577 A  
Art.no.:A771110-52 (dim)

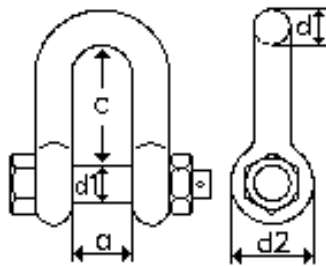

Ref. 1577 C  
Art.no.:A773110-42 (dim)

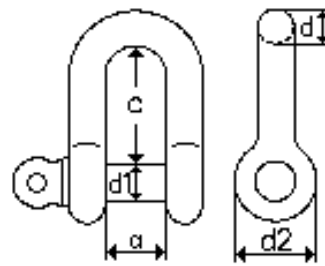

Ref. 1577 B  
Art.no.:A772110-42 (dim)

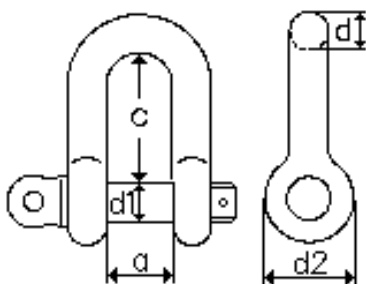

Ref. 1577 D  
Art.no.:A774110-30 (dim)

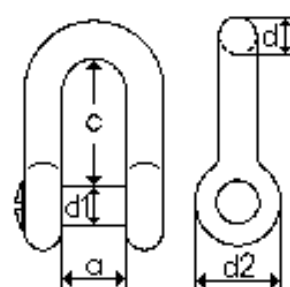

## Anja SMS 1619 Anchor Shackles

- Standard: SMS 1619
- Material: High Tensile Steel, Normalized / Normalisert St. 52-3
- Finish: Hot Dip Galvanized / Varmgalvanisert eller sort.
- Safety factor: 5,0 / Sikkerhetsfaktor 5,0
- Documentation: Test certificate can be supplied on request / Kan leveres med prøvesertifikat når det forlanges.

Art.no	WLL Ton S.F= 5	Nominal size d1	Bow dia d	Inside width a	Inside length c	Inside bow e	Outside eye d2	Weight pcs kg
Ref. figure	0,6	M10	11	15	34	26	20	0,13
Ref. figure	0,9	M12	13	20	45	35	26	0,25
Ref. figure	1,5	M16	16	24	55	42	33	0,50
Ref. figure	2,4	M20	19	28	65	50	40	0,85
Ref. figure	3,0	M22	22	30	70	52	46	1,20
Ref. figure	3,7	M24	25	32	75	56	50	1,60
Ref. figure	4,8	M27	28	36	85	62	55	2,20
Ref. figure	6,0	M30	32	40	94	68	62	4,40
Ref. figure	7,5	M33	35	44	104	77	68	5,70
Ref. figure	9,4	M39	38	48	115	84	75	7,50
Ref. figure	12,0	M42	42	52	125	92	82	11,00
Ref. figure	15,0	M45	45	58	140	100	95	

Forging tolerances: +/- 5% on inside width/length

Ref. 1619 B  
Art.no.: A619110-45 (dim)

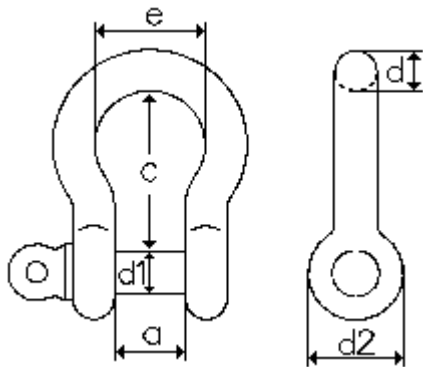

Ref. 1619 A  
Art.no.: A619216-45 (dim)

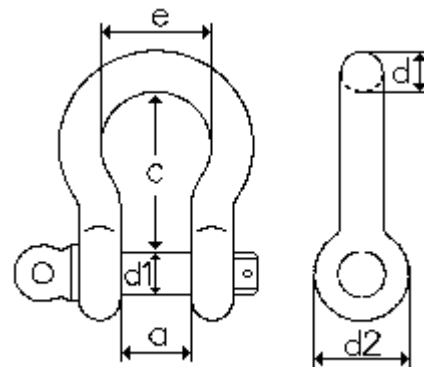

# SHACKLES

## Anja Large Dee Shackles

- Standard: Generally to BS 3032 with screwpin  
Hovedmål som BS 3032 m/kragepinn
- Material: High Tensile Steel, normalized  
Stålkvalitet St. 52-3 normalisert
- Finish: Selfcoloured  
Sort
- Safety factor: 5,0  
Sikkerhetsfaktor 5,0
- Documentation: Test Certificate  
Leveres med prøvesertifikat

Art.no	Size	SWL S.F. = 5	d	d1	a	c	Approx weight 100 pcs
A003305	3/16"	0,1	5	5	10	20	1,7
A003306	1/4"	0,15	6	6	13	25	3,5
A003308	5/16"	0,40	8,5	10	15	30	9,0
A003309	3/8"	0,60	9	10	19	38	11,0
A003311	7/16"	0,80	11	12	20	39	19,0
A003313	1/2"	1,0	13	16	24	52	33,0
A003316	5/8"	1,5	16	20	32	65	60,0
A003319	3/4"	2,0	19	22	38	76	97,0
A003322	7/8"	2,5	22	25	44	88	143,0
A003325	1"	3,0	25	28	51	102	220,0
A003328	1.1/8"	4,0	28	32	56	112	305,0
A003332	1.1/4"	5,0	32	35	64	128	435,0
A003335	1.3/8"	6,0	35	38	70	140	550,0
A003339	1.1/2"	7,0	38	42	76	152	740,0
A003342	1.5/8"	11,0	42	45	84	168	950,0
A003345	1.3/4"	13,0	45	50	90	180	1100,0

Forging tolerances: +/- 5% on inside width/length

Ref. 33 - DC

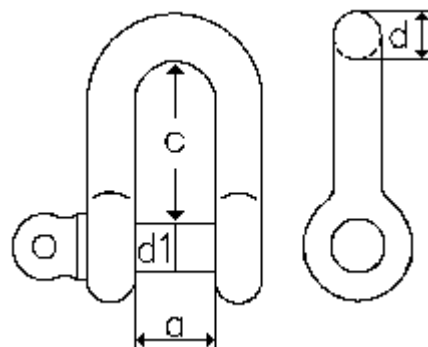

## Anja Commercial Shackles

- Norwegian Made Commercial Shackles with screw eye pin  
Norskprodusert handelssjakkell med øyepinn
- Dee or Bow Shape  
D- og H- form
- Finish: Hot Dip Galvanized  
Varmgalvanisert
- Material: Mild Steel  
Handelstål.

**NOT RECOMMENDED FOR LIFTING PURPOSE!**

**Anbefales ikke brukt til løfteformål!**

Art.no 50 H	Art.no 30 D	Size	d	d1	a	c	e	WLL ton S.F.=5	Approx weight 100 pcs
Dee/Bow									
A005005	A003005	3/16"	5	5	10	20/22	17	0,1	1,7
A005006	A003006	1/4"	6	6	13	25/25	17	0,15	3,5
A005008	A003008	5/16"	8	8	16	32/30	23	0,3	7,0
A005009	A003009	3/8"	9	9	19	38/33	28	0,5	11,0
	A003011	7/16"	11	11	22	44	33	0,6	17,0
A005012	A003012	1/2"	12	12	26	52/53	39	0,8	26,0
A005014	A003014	9/16"	14	16	29	52/60	45	1,2	44,0
A005016	A003016	5/8"	16	19	32	65/70	52	1,5	70,0
A005019	A003019	3/4"	19	22	38	76/86	65	2,0	114,0
A005022	A003022	7/8"	22	25	44	88/98	75	2,5	162,0
A005025	A003025	1"	25	28	51	102/114	85	3,0	245,0
	A003028	1.1/8"	28	32	56	112/—		4,0	345,0
	A003032	1.1/4"	32	35	64	128/—		5,0	450,0
	A003035	1.3/8"	35	38	70	140/—		6,0	595,0
	A003038	1.1/2"	38	42	76	152/—		7,0	7,4/8,4

Forging tolerances: +/- 5% on inside width/length

Ref. 50 H

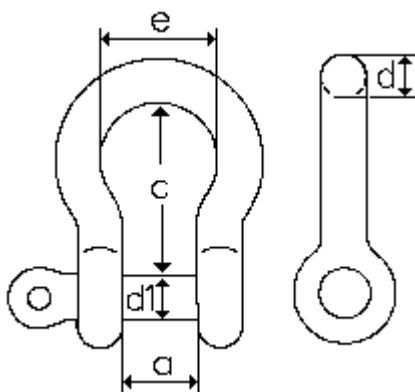

Ref. 30 D

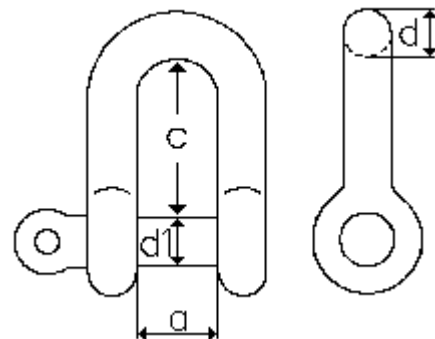

# SHACKLES

## Imported Commercial Shackles

- Equal size Bow and Pin  
Lik dimensjon bøyle og pinn
- Screw eye pin, Dee and Bow shape  
D- og H- form, øyepinn med krage
- Galvanized  
Elforsinket

**MUST NOT BE USED FOR LIFTING!**

**Må ikke anvendes til løft!**

Art.no 500 H	Art.no 300 D	Size	d	d1	a	c	e	Approx weight 100 pcs
A050005	A030005	M5	5	5	10	20	15	2
A050006	A030006	M6	6	6	12	24	18	3
A050008	A030008	M8	8	8	16	32	24	6
A050010	A030010	M10	10	10	20	40	30	9
	A030011	M11	11	11	22	44	33	21
A050012	A030012	M12	12	12	25	48	39	26
A050014	A030014	M14	14	14	28	53	42	38
A050016	A030016	M16	16	16	32	60	48	49
A050020	A030020	M20	19	19	38	74	57	80
A050022	A030022	M22	22	22	44	85	66	130
A050024	A030024	M24	25	25	51	97	75	200
A050027	A030027	M27	28	28	56	107	84	300
	A030030	M30	32	32	64	122	96	390
	A030033	M33	35	35	70	140	105	520
	A030039	M39	38	38	76	146	114	700

Forging tolerances: +/- 5% on inside width/length

Ref. 500 H

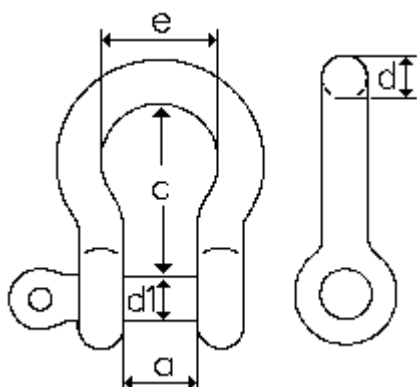

Ref. 300 D

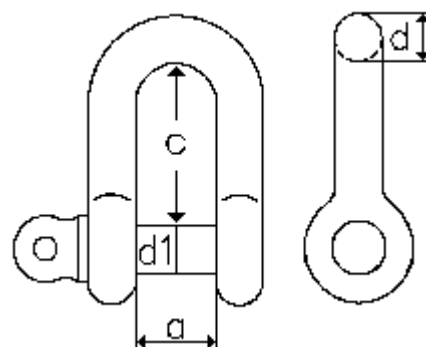

## Anja Standard Rigging screws

- Standard: Generally to B.S. 4429, Closed Body with locknuts on terminals  
Tilsvaret B.S. 4429, lukket hylse og stoppmuttere
- Material: M6 - M20 Mild Steel / St. 37
- Finish: Hot Dip Galvanized  
Varmgalvanisert
- Safety factor: 5,0  
Sikkerhetsfaktor 5,0
- Documentation: Sizes M10 - 2" are loadmarked and can be supplied with test certificate on request  
Dimensjoner M10 - 2" er lastmerket og kan på forlangende leveres med prøvesertifikat.

Art.no	Size/ threads S.F.=5	WLL tons	Load limit	Take up	B	N	L	M	K	H	G	F	Approx weight kg/ pcs
Ref. figure	M6		0,20	78	100	155	5	14	7	11	11	5	0,10
Ref. figure	M8		0,32	84	110	175	6	17	9	12	12	6	0,18
Ref. figure	M10	0,5		110	145	225	8	20	10	13	13	7	0,28
Ref. figure	M12	0,7		115	195	315	10	30	13	30	15	10	0,66
Ref. figure	M16	1,2		185	230	380	12	44	18	40	20	12	1,20
Ref. figure	M20	1,5		210	270	450	16	50	20	50	24	16	2,30
Ref. figure	M22	2,2		230	295	500	20	60	25	50	24	16	3,30
Ref. figure	M24	3,2		250	325	555	22	65	28	56	28	19	4,60
Ref. figure	M30	1 1/4"	4,8	290	370	680	27	85	3	70	35	22	8,50
Ref. figure	M39	1 1/2"	6,0	300	400	760	33	100	45	80	40	25	14,50
Ref. figure	M45	1 3/4"	8,5	290	400	760	38	105	50	90	45	30	20,80
Ref. figure	M50	2"	1,0	290	400	820	45	120	58	100	45	35	24,0

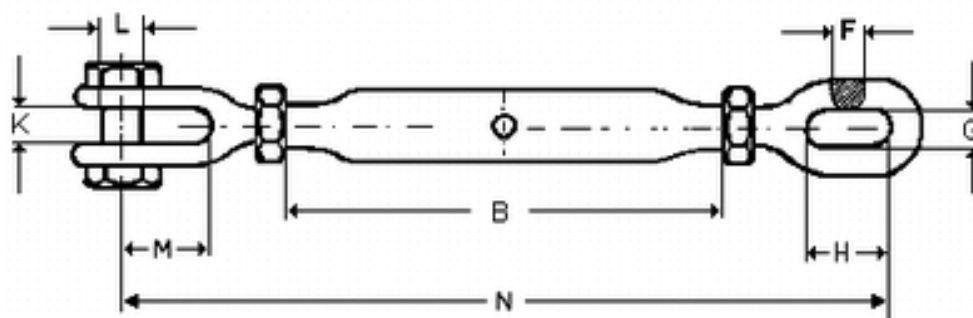

Ref.	JAW / JAW	401	Art.no.: A401406-50 (dim)
	JAW / EYE	402	Art.no.: A402406-50 (dim)
	EYE / HOOK	403	Art.no.: A403406-20 (dim)
	EYE / EYE	404	Art.no.: A404406-20 (dim)

# RIGGINGSREWS

## Anja Alloy Rigging screws

- Standard: Load Rated similar to U.S. Fed. Spec. FF-T-791.b  
Arbeidslaster som U.S. Fed. spec. FF-T-791.b
- Range: Closed Body 2,5T to 17T, Larger sizes Open Body  
Leveres med lukket hylse fra 2,5 - 17T, større dimensjoner åpen hylse
- Material: High Tensile Steel, Quenched and Tempered  
Legert stål, seigherdet
- Finish: All parts hot dip galvanized  
Alle komponenter varmforsinket
- Safety factor: 5,0  
Sikkerhetsfaktor 5,0
- Documentation: Supplied with Test Certificate, 3.1.B material certificate available on request  
Leveres med godkjent prøvesertifikat, sporbart 3.1.B materialsertifikat kan leveres på forlangende.

Art.no	Size/ thread	WLL 5:1 tons	Take up	B	N	K	L	M	F	G	H	Approx weight kg/pcs
Ref. figure	M20	2,5	210	270	455	20	16	50	16	24	50	2,3
Ref. figure	M24	5,0	250	340	570	28	22	65	19	28	56	4,6
Ref. figure	M30 1.1/4"	7,0	270	370	680	38	27	85	22	35	70	8,0
Ref. figure	M39 1.1/2"	10,0	300	420	790	45	33	100	25	40	78	14,0
Ref. figure	M45 1.3/4"	13,0	360	500	870	50	39	105	30	45	90	24,0
Ref. figure	M50 2"	17,0	450	600	1030	58	45	120	35	45	100	38,0
Ref. figure	M60* 2.1/2"	27,2	600	800	1490	75	57	140				73,0
Ref. figure	M70* 2.3/4"	34,0	600	800	1570	89	70	145				98,0

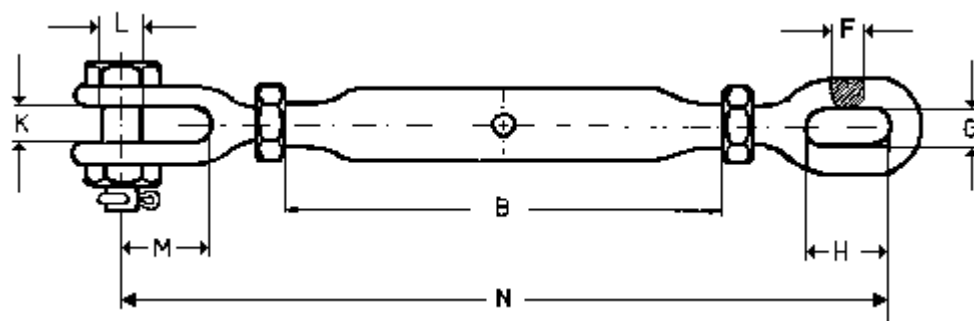

Ref.	JAW / JAW	801	Art.no.: A801420-50 (dim)
	JAW / EYE	802	Art.no.: A801420-50 (dim)
	EYE / EYE	804	Art.no.: A801420-50 (dim)

## Standard Commercial Thimbles / Hjertekauser

- Material: Mild Steel / handelsstål
- Finish: Galvanized / galvanisert

Art.no	Dia Rope	Groove width	Overall length		Overall width	Inside length	Inside width	Approx weight per 100 pcs kg
	mm	a mm	L inches	L mm	b mm	l mm	c mm	
A060004	4	4	1	25	19	16	11	0,4
A060005	5	5	1,25	31	22	22	16	0,8
A060006	6	6	1,5	37	29	26	19	1,4
A060007	7	7	1,75	44	32	32	22	2,0
A060008	8	8	2	51	38	34	24	2,8
A060009	9	9	3,5	57	42	38	29	3,0
A060010	10	10	2,25	64	44	42	32	4,8
A060012	12	12	3	76	57	51	38	8,0
A060016	16	16	3,5	89	64	60	42	15,0
A060018	18	18	4	102	69	67	45	22,0
A060020	20	20	4,5	115	79	76	51	25,0
A060022	22	22	5	127	89	83	54	32,0
A060024	24	24	5,5	140	102	88	64	46,0
A060026	26	26	6	152	105	102	68	66,0
A060030	30	30	7	178	121	115	79	80,0

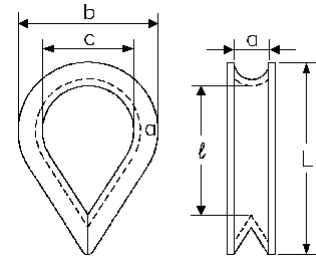

## Heavy Duty Stub-End Thimbles / Stub-end hjertekauser for løft

- Material: Mild Steel / handelsstål
- Finish: Galvanized / galvanisert

Art.no	Dia Rope	Groove width	Overall length		Inside length	Inside width	Back thickness	Approx weight per 100 pcs kg
	mm	a mm	L inches	L mm	l mm	c mm	S mm	
A060108	8	8	2	51	35	22	4	6
A060110	10	10	2 1/2	64	47	30	4	7
A060112	12	12	3	76	57	35	5	14
A060114	14	14	3 1/2	89	65	45	6	22
A060116	16	16	4	102	76	50	6	24
A060118	18	18	4 1/2	114	86	53	8	43
A060120	20	20	5	127	94	60	9	65
A060122	22	22	5 1/2	140	107	65	10	93
A060124	24	24	6	152	114	70	10	102
A060128	28	28	7	178	130	80	10.5	135
A060132	32	32	8	203	157	100	10.5	162
A060136	36	36	9	229	177	115	12	363
A060140	40	40	10	254	198	120	12	376

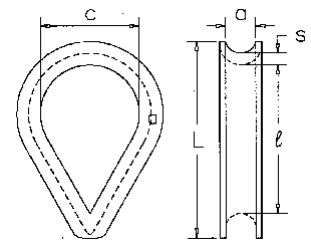

# THIMBLES

## Short Rope Thimbles / Trossekauser

Art.no	Overall length	Overall width	Inside length	Inside width	Groove width	Approx weight per 100 pcs kg
	a inches	n mm	k mm	p mm	r mm	
A060332	4	75	78	50	32	34
A060340	5	110	95	65	40	80
A060348	6	120	115	75	48	90
A060356	7	140	140	85	56	180
A060364	8	160	160	105	64	310

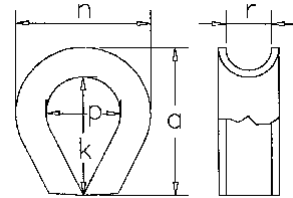

## Anja Eyebolts

- Type: Large Welded Eye, No Collar  
Stort sveist øye, uten krage
- Threads: Machine Thread or Thread for Wood  
Maskingjenger eller tregjenger
- Material: Mild Steel  
Handelsstål
- Finish: Hot Dip Galvanized  
Varmforsinket

**NOTE: Must not be used for lifting purpose / må ikke brukes til løfteformål**

Art.no Ref. 653	Art.no Ref. 650	Size	A	B	C	E	L	Weight 100 pcs	Packing
A811003	A801003	M10 x 75	10	20	8	30	75	5	10
A811004	A801004	M10 x 100	10	20	8	30	100	10	10
A811005	A801005	M10 x 125	10	20	8	30	125	12	10
A811006	A801006	M10 x 150	10	20	8	30	150	13	10
A811204	A801204	M12 x 100	12	25	10	40	100	20	10
A811205	A801205	M12 x 125	12	25	10	40	125	25	10
A811206	A801206	M12 x 150	12	25	10	40	150	28	10
A811208	A801208	M12 x 200	12	25	10	40	200	32	10
A811604	A801604	M16 x 100	16	30	12	40	100	33	10
A811605	A801605	M16 x 125	16	30	12	40	125	35	10
A811606	A801606	M16 x 150	16	30	12	40	150	41	1
A811608	A801608	M16 x 200	16	30	12	40	200	48	1
A812005	A802005	M20 x 125	20	35	14	45	125	54	1
A812006	A802006	M20 x 150	20	35	14	45	150	62	1
A812008	A802008	M20 x 200	20	35	14	45	200	72	1
A812010	A802010	M20 x 250	20	35	14	45	250	84	1

Ref. 653

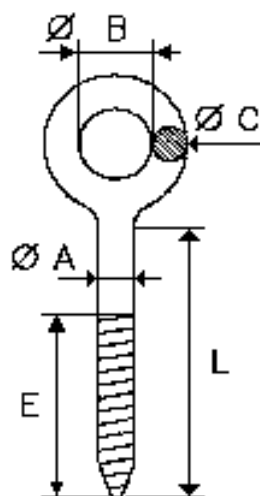

Ref. 650

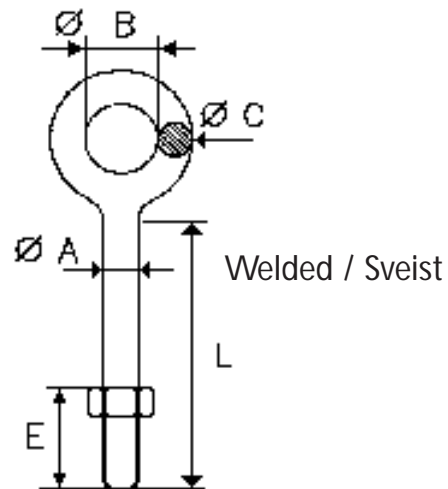

# EYEBOLTS

## Anja Eyebolts with Collar

- Type: Small Eye and Collar, with or without large ring fitted in eye  
Lite øye og krage, leveres også med båtring montert i øyet
- Threads: Machine Thread or Thread for wood  
Maskingjenger eller tregjenger
- Material: Mild Steel  
Handelsstål
- Finish: Hot Dip Galvanized  
Varmforsinket

**NOTE: Must not be used for lifting purpose – Må ikke brukes til løfteformål**

Art.no	Size Thread	A	B	C	D	E	T	L	Packing
Ref. figure	M6	6	10	5	40	30	6	50	10
Ref. figure	M8	8	12	6	45	38	7	60	10
Ref. figure	M10	10	13	7	50	46	8	75	10
Ref. figure	M12	12	15	8	50	60	10	100	10

Ref. 654  
Art.no.: A865406-12 (dim)

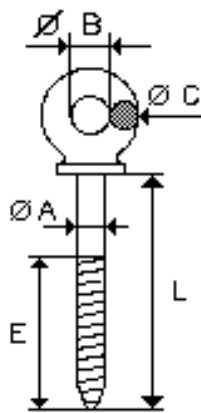

Ref. 651  
Art.no.: A865106-12 (dim)

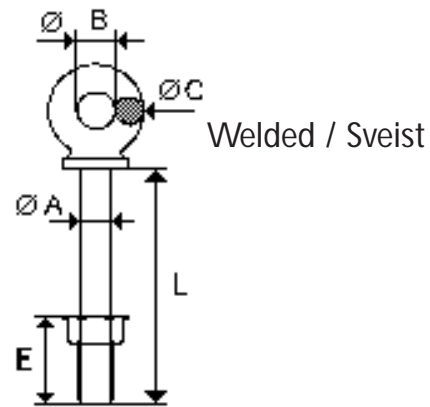

Ref. 655  
Art.no.: A865506-12 (dim)

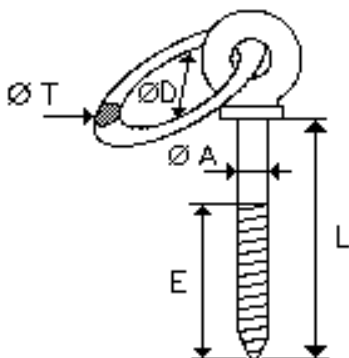

Ref. 652  
Art.no.: A865206-12 (dim)

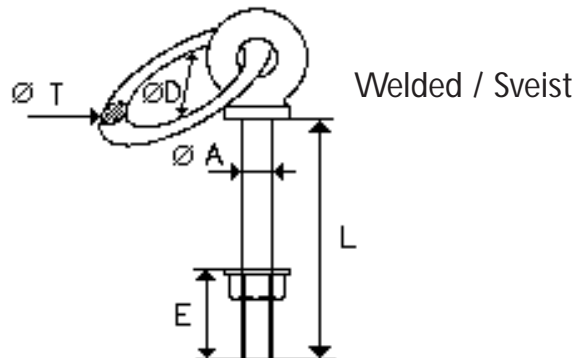

## Material AISI 316. Highly polished

### Anja Stainless Steel Rigging Screws

- Closed Body with stopnuts
- Machined Jaws

No. 763 Two Narrow Jaws

No. 6312 Narrow Jaw and Swage Stud Terminal

### Anja rustfrie strekkskruer

Lukket hylse med stoppmuttere

Maskinerte gafler

Nr. 763 Med to smale gafler

Nr. 6312 Med smal gaffel og gjengeterminal

Art.no	Size UNF	Wire mm	Length body B	Length min. L1	Length max. L2	Bolt dia D	Inside jaw A	M	F	Break load ton	Weight kg/100
A763806	1/4"	3	90	140	205	5,0	5,2	10	11	1.3	9
A763808	5/16"	4	100	160	235	6,0	7,8	12,5	15	2.1	15
A763810	3/8"	5	115	185	265	8,0	9,1	14	17	3.2	25
A763811	7/16"	6	130	210	305	9,5	10,1	17	20	4.2	35
A763812	1/2"	7	155	260	380	11,0	11,0	20	22	5.7	55
A763816	5/8"	8	190	315	460	12,7	13,0	22	25	6.7	95
A763820	3/4"	10	240	410	565	16,0	17,0	30	35	11.0	190

Dimension stud terminal  
no 712 on page 24

Mål på terminal  
nr 712 på s. 24

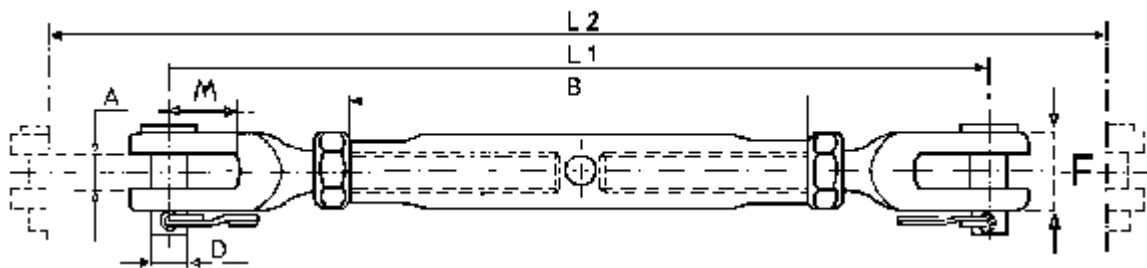

No 764 Two Wide Jaws

Nr 764 Med to brede gafler

Art.no	Size UNF	Wire mm	Length body B	Length min. L1	Length max. L2	Bolt dia D	Inside jaw A	M	F	Break load ton	Weight kg/100
A764806	1/4"	3	90	145	210	6,0	7,8	12,5	15	1.5	13
A764808	5/16"	4	100	165	240	8,0	9,1	14	17	2.3	18
A764810	3/8"	5	115	195	270	9,5	10,1	17	20	3.5	30
A764811	7/16"	6	130	220	300	11,0	11,0	20	22	4.6	40
A764812	1/2"	7-8	155	270	375	12,7	13,0	20	25	6.2	60
A764816	5/8"	8-10	190	320	450	15,0	16,0	30	30	7.7	110
A764820	3/4"	10-12	240	420	570	18,0	20,0	35	45	12.5	210
A764824	1"	14-16	325	520	740	22,0	28,0	65	51	20.0	510

# STAINLESS STEEL

Material AISI 316. Highly polished

## Anja Stainless Steel Swage Terminals

• Machined and drilled

## Anja Rustfrie Endestykker

• Maskinert og boret

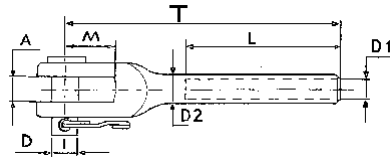

No. 710

Art.no	Size mm	Wire mm	Outside	Inside	Inside	Jaw	Bolt			Weight kg./100
			dia D2	dia D1	length L	opn. A	dia D	T	M	
A710806	M6	3	6,3	3,2	36	5,2	5,0	54	10	3
A710808	M8	4	7,4	4,2	46	7,8	6,0	68	12,5	4
A710810	M10	5	9,1	5,3	53	9,1	8,0	83	14	7
A710811	M11	6	12,4	6,4	66	10,1	9,5	100	17	14
A710812	M12	7	14,4	7,4	72	11,0	11,0	110	20	18
A710816	M16	8	16,0	8,4	78	13,0	13,0	120	22	29
A710820	M20	10	17,9	10,4	84	16,0	16,0	140	30	42
A710821	M20	12	20,0	12,5	90	20,0	18,0	160	35	70

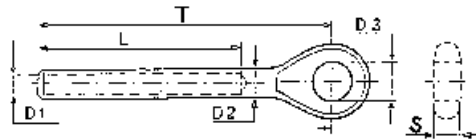

No. 711

Art.no	Size mm	Wire mm	Outside	Inside	Inside	Eye	Eye			Weight kg/100
			dia D2	dia D1	length L	opn D3	thickness S	T		
A711806	M6	3	6,3	3,5	38	6,5	4,0	55	1	
A711808	M8	4	7,5	4,4	45	8,5	5,0	67	3	
A711810	M10	5	9,0	5,3	51	10,5	6,0	76	4	
A711811	M11	6	12,5	6,5	64	13,0	8,0	94	9	
A711812	M12	7	14,2	7,5	70	13,0	9,0	104	11	
A711816	M16	8	16,0	8,4	83	14,5	10,0	118	17	
A711820	M20	10	17,8	10,5	89	16,3	11,0	142	25	

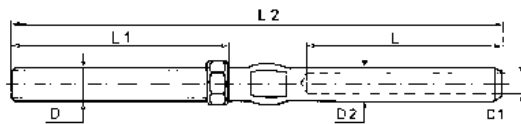

No. 712

Art. no	Thread UNF D	Wire mm	Outside	Inside	Inside	Length	Length	NV	Weight pcs/100
			dia D2	dia D1	length L	thread L1	total L2		
A712806	1/4"	3	6,3	3,2	36	43	96	5	2
A712808	5/16"	4	7,4	4,2	46	53	120	6	4
A712810	3/8"	5	9,1	5,3	53	60	135	8	6
A712811	7/16"	6	12,4	6,4	66	70	155	11	8
A712812	1/2"	7-8	14,4	7,4	72	80	175	12	13
A712816	5/8"	8-10	16,0	8,4	78	92	200	14	28
A712820	3/4"	10	17,9	10,4	84	114	225	16	35
A712821	3/4"	12	20	12,5	90	125	250	17	55

For Stud Terminals specify UNF or metric thread.

Bestilles med UNF eller metriske gjenger.

No. 712

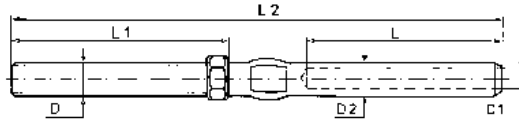

Art.no	Thread metric	Wire mm	Outside dia D2	Inside dia D1	Inside length L	Length thread L1	Lengt total L2	NV	Weight pcs/100
A712906	M6	3	6,3	3,2	36	43	96	5	2
A712908	M8	4	7,4	4,2	46	53	120	6	4
A712910	M10	5	9,1	5,3	53	60	135	8	6
A712911	M11	6	12,4	6,4	66	70	155	11	8
A712912	M12	7	14,4	7,4	72	80	175	12	13
A712913	M12	8	16,0	8,4	80	90	200	14	13
A712916	M16	8	16,0	8,4	80	90	200	14	28
A712917	M16	10	17,9	10,4	90	100	220	15	28
A712920	M20	10	17,9	10,4	90	115	225	15	35
A712921	M20	12	20,0	12,5	108	115	245	17	55

For Stud Terminals specify UNF or metric thread.

Bestilles med UNF eller metriske gjenger.

## Material AISI 316. Highly polished

### Anja Stainless Steel Rigging Screws

- Closed Body with Pelican hook
- Machined Parts

No. 773 Jaw and Pelican Hook

No. 7312 Bolt Terminal and Pelican Hook

### Anja rustfrie strekkskruer

Lukket hylse med pelikankrok

Maskinert

Nr. 773 Gaffel og pelikankrok

Nr. 7312 Bolt endestykke og pelikankrok

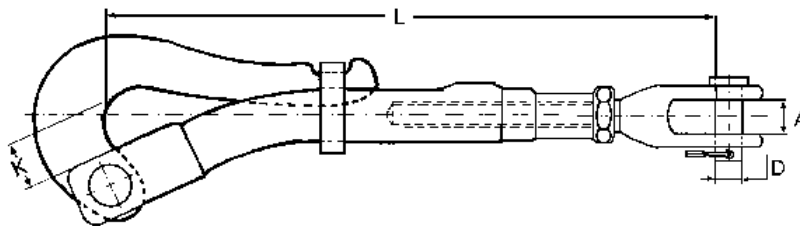

Art.no	Size UNF	Wire mm	Length min L	Length max L	Bolt dia D	Inside jaw A	Inside hook K	MBL ton	Weight 100 pcs
A773808	5/16"	4	140	175	6,0	7,8	10	0,18	14
A773811	7/16"	6	185	230	9,5	10,1	18	0,37	32

# STAINLESS STEEL

## Anja Stainless Steel Dee Shackles

- Material: AISI 316
- Finish: Highly polished  
Høyglanspolert

Forged Shackles to the utmost Quality and Performance  
Smidde sjakler for fremragende kvalitet og sikkerhet.

NOTE: Deformation load Appr . 2 x WLL – Deformasjonslast (flyt) ca 2 x WLL  
Oversized pin from M16 – Overdimensjon pinn fra M16.

Art.no No 735	Art.no No 730	Size				MBL Ton	WLL Ton	Weighth kg/100
		d1	a	c	d			
	A073004	M4	8	17	4,0	0,8		1
	A073005	M5	10	20	5,0	1,2		2
	A073006	M6	12	24	6,0	1,8		4
	A073008	M8	16	32	8,0	2,8	0,4	7
	A073010	M10	20	38	9,5	4,3	0,6	11
	A073011	M11	22	44	11,0	5,2	7,5	17
A073512	A073012	M12	26	50	12,0	6,5	0,9	25
A073516	A073016	M16	24	52	13,0	12,0	1,5	40
A073520	A073020	M20	28	65	16,0	16,0	2,5	60
A073522	A073022	M22	30	72	19,0	20,0	3,0	90
A073524	A073024	M25	32	78	19,0	28,0	4,0	110
A073530	A073030	M30	40	94	25,0	40,0	6,0	240

Larger sizes upon inquiry / Større dimensjoner på forespørsel

No. 735 with Safety Bolt  
Available sizes M12 - M30

No. 730-D with screw eye pin  
Available sizes M4 - M30

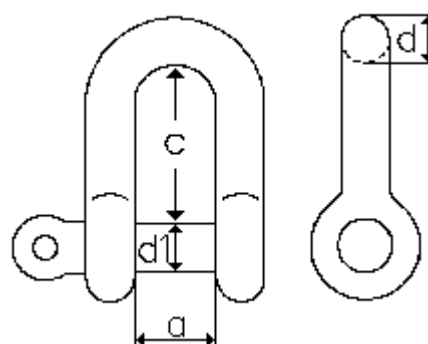
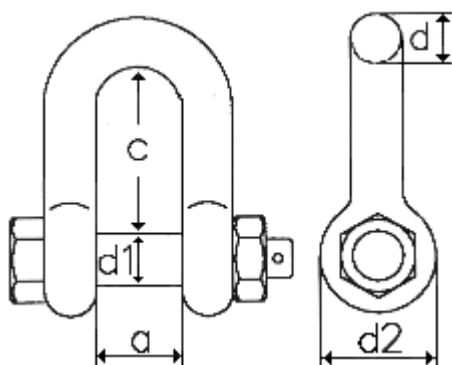

## Anja Stainless Steel Bow Shackles

- Material: AISI 316
- Finish: Highly polished / Høyglanspolert

Forged Shackles to the utmost Quality and Performance / Smidde sjakler for fremragende kvalitet og sikkerhet.

NOTE: Deformation load Appr. 2 x WLL / Deformasjonslast (flyt) ca 2 x WLL  
Oversized pin from M16 / Overdimensjon pinn fra M16

Art.no	Size						MBL Ton	WLL Ton	Weight 100 pcs
	d1	d	a	c	e	d2			
Ref. figure	M4	4	8	18	13	9	0,8		1
Ref. figure	M5	5	10	18	15	10	1,2		2
Ref. figure	M6	6	12	22	17	12	1,8		4
Ref. figure	M8	8	16	30	23	16	2,8	0,4	7
Ref. figure	M10	9,5	20	36	27	20	4,3	0,6	11
Ref. figure	M12	12	25	47	37	26	6,5	0,9	25
Ref. figure	M16	13	25	47	33	33	11,0	1,5	37
Ref. figure	M20	16	28	60	42	40	15,0	2,5	65
Ref. figure	M22	19	30	67	51	47	18,0	3,0	100
Ref. figure	M25	22	36	84	57	50	25,0	4,0	170
Ref. figure	M30	25	40	95	66	58	40,0	6,0	250

Larger sizes upon inquiry / Større dimensjoner på forespørsel

No. 750-H with screw eye pin  
Available sizes M4 - M 30  
Art.no.: A075006-30 (dim)

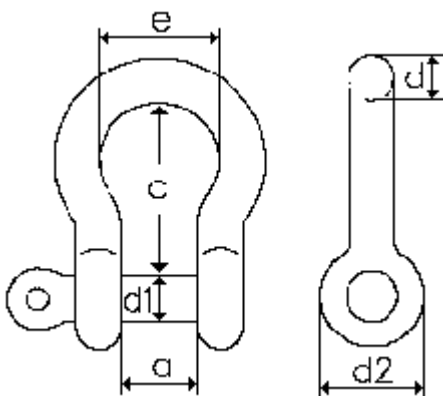

No. 755-H with safety bolt  
Available sizes M12-M30  
Art.no.: A075012-30 (dim)

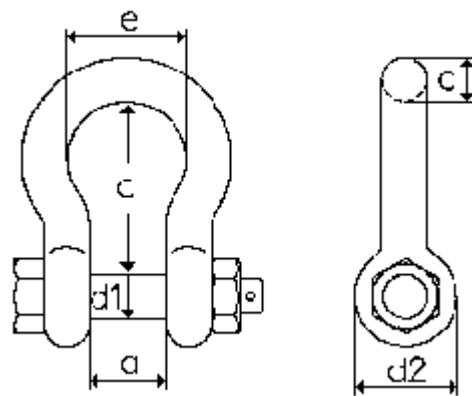

# STAINLESS STEEL

## Anja Stainless Steel Forged Shackles

- Material: AISI 316
- Finish: Highly polished / Høyglanspolert

Forged Shackles to the utmost Quality and Performance / Smidde sjakler for fremragende kvalitet og sikkerhet.

Art.no	Size D1	A	C	D	MBL ton	Weigth 100/kg
A073104	M4	8	30	4	0,8	1
A073105	M5	10	40	5	1,2	2
A073106	M6	12	50	6	1,8	4
A073108	M8	16	64	8	2,8	9

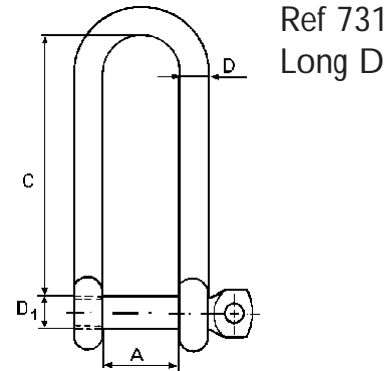

Art.no	Size D1	A	C	D	MBL ton	Weigth 100/kg
A074004	M4	8	18	4	0,8	1
A074005	M5	10	18	5	1,2	2
A074006	M6	12	22	6	1,8	4
A074008	M8	16	30	8	2,8	7
A074010	M10	20	33	9,5	4,3	11

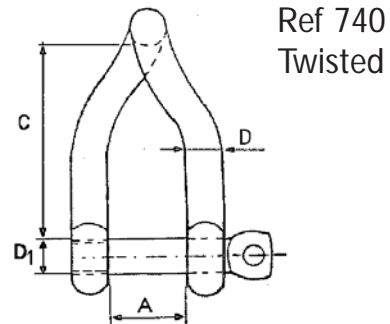

Art.no	Size D1	A	C	D	MBL ton	Weigth 100/kg
A074104	M4	8	28	4	0,8	1
A074105	M5	10	36	5	1,2	2
A074106	M6	12	42	6	1,8	4
A074108	M8	16	56	8	2,8	9

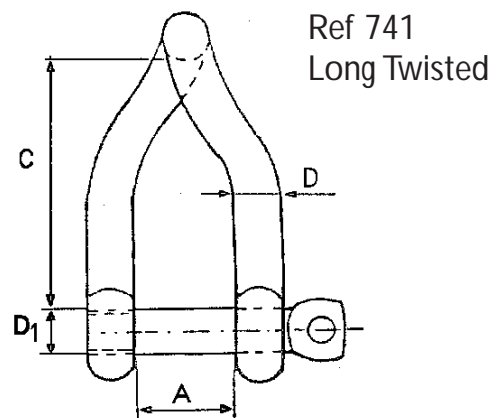

## Wooden Blocks for Manilla and Syntetic Rope Regular Wood Shell Blocks

Steel straps and forged end fittings hot dip galvanized  
Becket furnished on all blocks, round thimbles optional  
Supplied with loose round eye side hook or shackle  
Swivel hook and eye quoted on request



Art. no. 201 With hook

Art. no. 203 With shackle

Bearing code: Nylon = N, common iron = C, bronze bush = B.

NOTE: Ultimate load 4,5 times Resultant Working Load Limit (RWLL). For single blocks certified WLL is half of RWLL

Block Sizes Inches	Rope Dia. inches	Resultant Working Load Limit (kps)			Appr. weigth each (kgs)					
		1	2	3	Iron sheave			Nylon sheave		
					1	2	3	1	2	3
3"	3/8"	200	350	500	0,3	0,4	-	0,3	0,4	-
4"	1/2"	400	650	800	0,8	1,1	2,0	0,6	0,8	1,0
5"	5/8"	500	800	1000	1,3	1,9	2,9	1,1	1,4	1,7
6"	3/4"	800	1100	1400	1,9	2,9	3,7	1,5	2,0	2,5
7"	7/8"	900	1350	1700	3,3	4,8	6,0	2,4	3,2	3,8
8"	1"	1200	1700	2100	4,2	6,0	7,7	3,3	4,5	5,2
10"	1 1/8"	1800	2700	3400	8,0	11,2	14,4	-	-	-

MERK: Min. bruddlast oppheng 4,5 ganger RWLL

Enkle blokker sertifiseres for 50% av RWLL

Trebløkker for Tauverk

Beslag og oppheng er varmgalvanisert

Leveres med hunsvott, kauser monteres etter ønske

Krok eller sjakkel i toppbeslaget

Krok eller øye med svivel tilbys på forespørsel

Blokkskiver av nylon eller støpejern, evt. med bronseforing.

## WOODEN BLOCKS

### Wooden Blocks for Manilla and Syntetic Rope Wood Shell Snatch Blocks With Iron Rolls

A rigid construction for utmost performance  
Drop forged heads and links  
Steel straps and forgings all hot dip galvanized  
Furnished with swivel hook or swivel eye  
Common Iron Sheaves

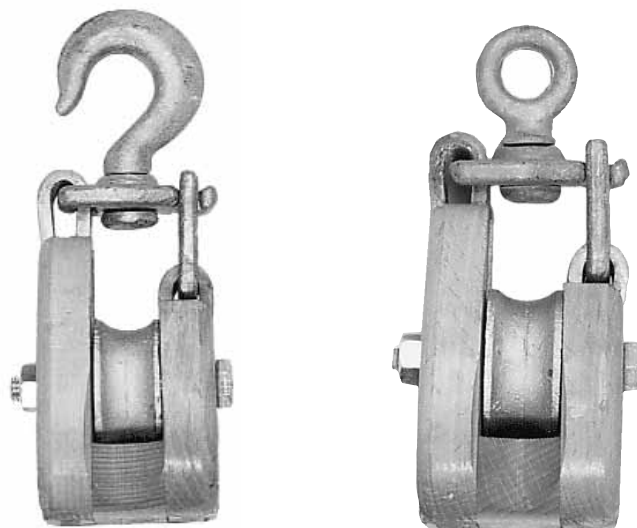

NOTE: Ultimate load 4,5 times Resultant Working Load Limit (RWLL)  
Can be marked with WLL half the RWLL

Block Sizes Inches	Rope Dia. inches	Roll Dia.xThick mm	Opening		Resultant Safe work Load kps	Appr.weighth	
			Hook mm	Eye mm		Hook kgs	Eye kgs
4"	1/2" - 5/8"	50x24	20	17	500	1,2	1,0
6"	3/4" - 7/8"	76x32	30	23	950	3,0	2,6
8"	7/8" - 1"	125x45	40	27	1900	6,4	5,7
10"	1" - 1/4"	140x57	45	38	2600	10,5	9,3

MERK: Min. bruddlast oppheng 4,5 ganger RWLL  
Blokkene kan merkes med WLL halvparten av RWLL

Trehus kasteblokker med støpejernsroller for tauverk  
Senkesmidd toppbeslag og oppheng  
Varmgalvanisert beslag og oppheng  
Leveres med sviveløye eller svivelkrok

## Spare Parts and Fittings

### Sheaves for regular wood blocks / Måltabell for vanlige blokkskiver

Bearing code: Common iron (C), Bronze bush (B), Nylon (N)

For block size	Dia. x Thickness mm	Hole dia. mm	Rope dia. inches	Weight each	
				iron kgs.	nylon kgs.
3"	45 x 14	6,5	3/8"	0,09	0,01
4"	58 x 19	9,7	1/2"	1,18	0,02
5"	70 x 22	9,7	5/8"	0,30	0,04
6"	81 x 24	11,6	3/4"	0,50	0,06
7"	100 x 30	13	7/8"	0,65	0,10
8"	120 x 30	16,3	1"	1,05	0,14
10"	138 x 32	19,5	1 1/8"	1,40	-



### Iron Rolls for Wood Snatch Blocks / Måltabell ruller for kasteblokker

For block size	Dia. x Thickness mm	Hole dia. mm	Rope dia. inches
4"	50 x 24	11	0,2
6"	76 x 32	14	0,5
8"	125 x 45	19	1,7
10"	140 x 57	23	3,0



### Drop Forged Round Eye Loose Hooks, Normalized and hot dip galvanized / Måltabell senkesmidde kroker for treblokker, krokene er normalisert og varmgalvanisert

For block size	Opening eye mm	Gap hook inches	Weight each kgs.
3"	16	1/2"	0,1
4"	22	5/8"	0,2
5"	24	3/4"	0,3
6"	29	7/8"	0,5
7"	29	7/8"	0,5
8"	36	1 1/8"	0,9
10"	47	1 1/2"	2,3







# TESTING AND CERTIFICATES

## Test Certificates

All forged components may be pull tested and supplied with the relevant Test Certificate issued by the manufacturer. Further test certificates by official classification authorities can be supplied on request.

## Material Documentation

3.1.B certificates of the raw material or the material in the finished condition may be supplied when stated in the catalogue specification for the relevant product.

## Marking

The «Anja» products which can be supplied with a workcertificate are normally marked with:

- Working Load Limit (metric tons)
- The manufacturer's logo
- Tracability code
- Grade of steel (shackles only)
- CE mark to confirm conformity with the Machinery Directive (shackles only)

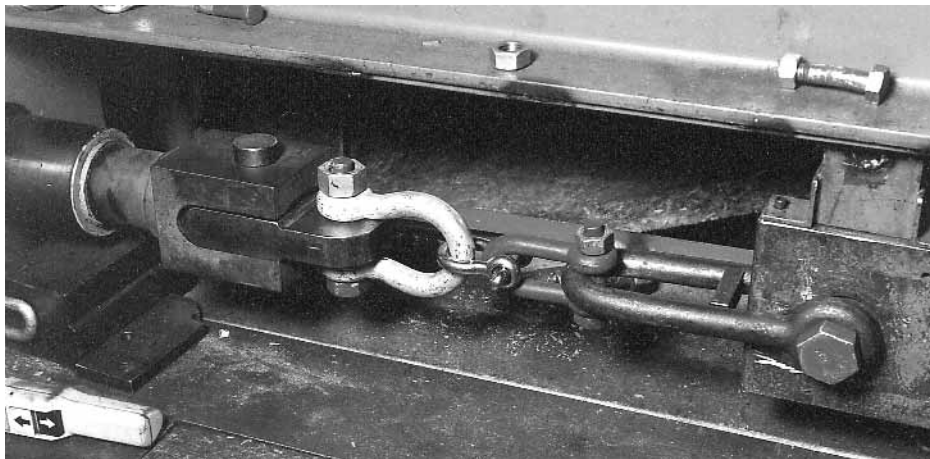

## Prøvesertifikater

Alle smidde produkter kan strekkprøves og leveres med prøvesertifikat fra produsenten. På forlangende kan også sertifikater fra internasjonale classeselskaper ( DnV, Lloyds etc.) leveres.

## Materialdokumentasjon

Når det fremgår av katalogen, kan produktene leveres med 3.1.B sertifikat.

## Merking

Produkter som leveres med prøvesertifikat er normalt merket som følger:

- Største tillatte arbeidslast (WLL) i tonn.
- Produsentens logo
- Sporbarhetsmerking
- Materialklasse (3, 6 eller 8 ), gjelder kun sjakler
- CE merke som bekrefter samsvar med Maskindirektivet, kun sjakler

## SAFETY AND RELIABILITY

Within the lifting and tackle industry onshore and offshore there is a growing awareness and concern about product safety and reliability.

In Europe this is also expressed in The Machinery Directive 89/392/EEC and later amendments which further highlights the responsibility of the manufacturer, distributor and end user of lifting gear.

The «Anja» products are specified, monitored and documented in compliance with the most stringent requirements for the product concerned. A certified ISO 9001-2000 system is an evidence of our quality standard.

We appreciate the trust shown us when specifying, ordering and using the «Anja» products.

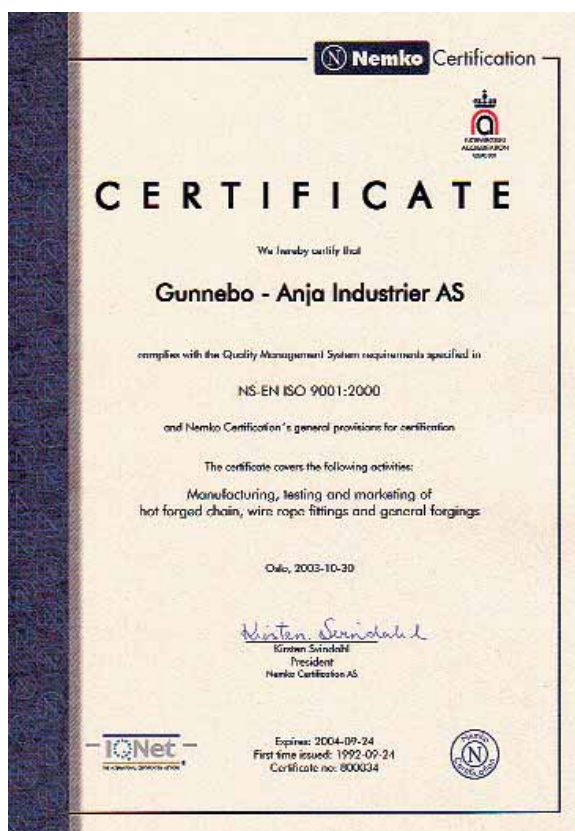

Det registreres stadig skjerpene krav til sikkerhet og pålitelighet for utstyr og komponenter som brukes til løft og surring både offshore og innenfor landbasert industri.

Dette fremkommer for eksempel i Maskindirektivet 89/392/EEC med senere tillegg hvor spesielt produsentenes, distributørens og brukerens ansvar fremheves.

Våre «Anja» produkter er spesifisert, kontrollert og dokumentert i henhold til de strengeste krav for det aktuelle produktet.

Vårt ISO 9001-2000 sertifiserte kvalitetskontrollsystemer er grunnlaget for vårt kvalitetsarbeid.

Vi er innforstått med våre kunders tillitt når de spesifiserer, bestiller og anvender «Anja» produkter.

**Gunnebo Industrier AB**

P.O. Box 44

SE-730 60 Ramnäs, Sweden

Tel: +46 (0)220 384 00

Fax: +46 (0)220 384 98

E-mail: [export@gunnebolifting.com](mailto:export@gunnebolifting.com)

[www.gunnebolifting.com](http://www.gunnebolifting.com)

A company within the Gunnebo Group

